

The Generous Ordinary

a short story of the 'Dublin House'

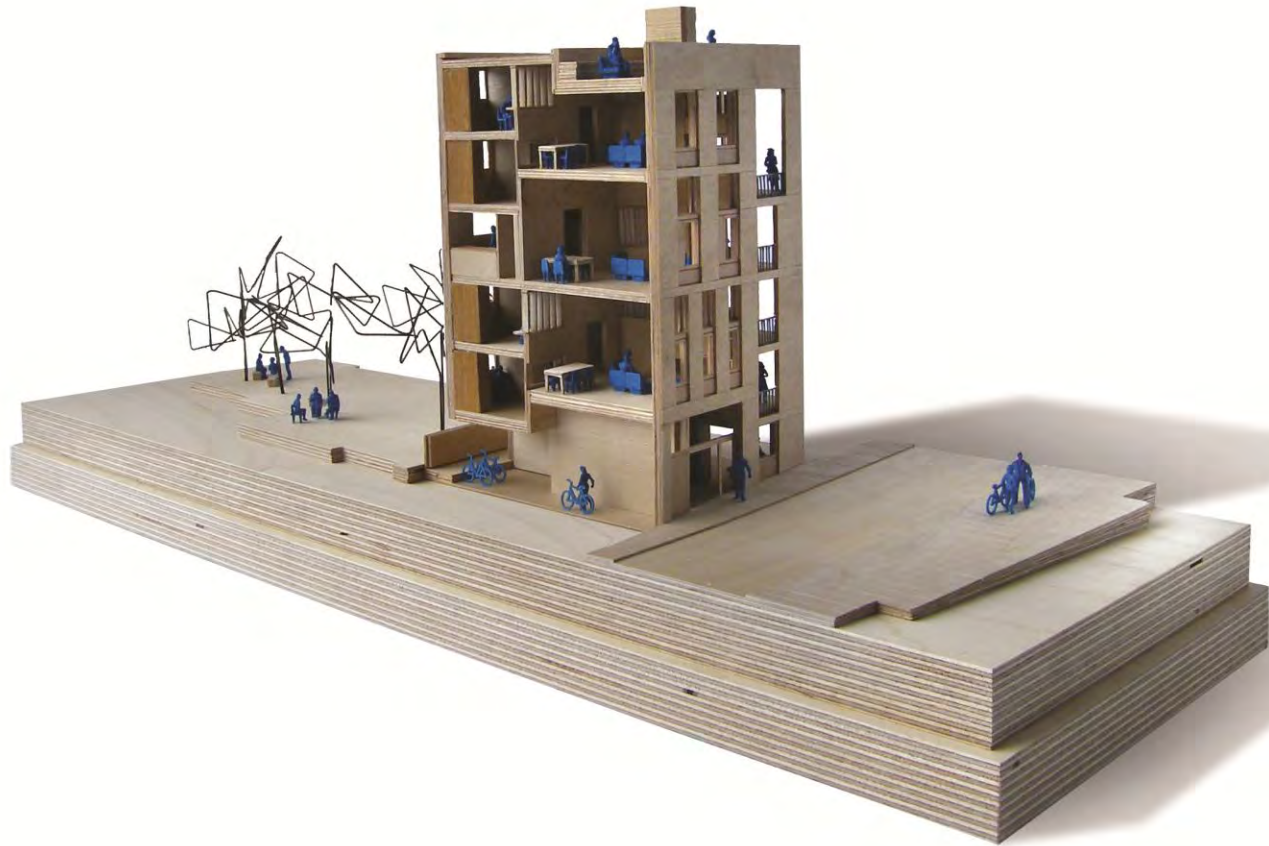

Presentation to 2014 PChouse Modern Design Awards
Ali Grehan, Dublin City Architect
November 2014



○ Dublin

○ Shanghai

Dublin to Shanghai
9340 km

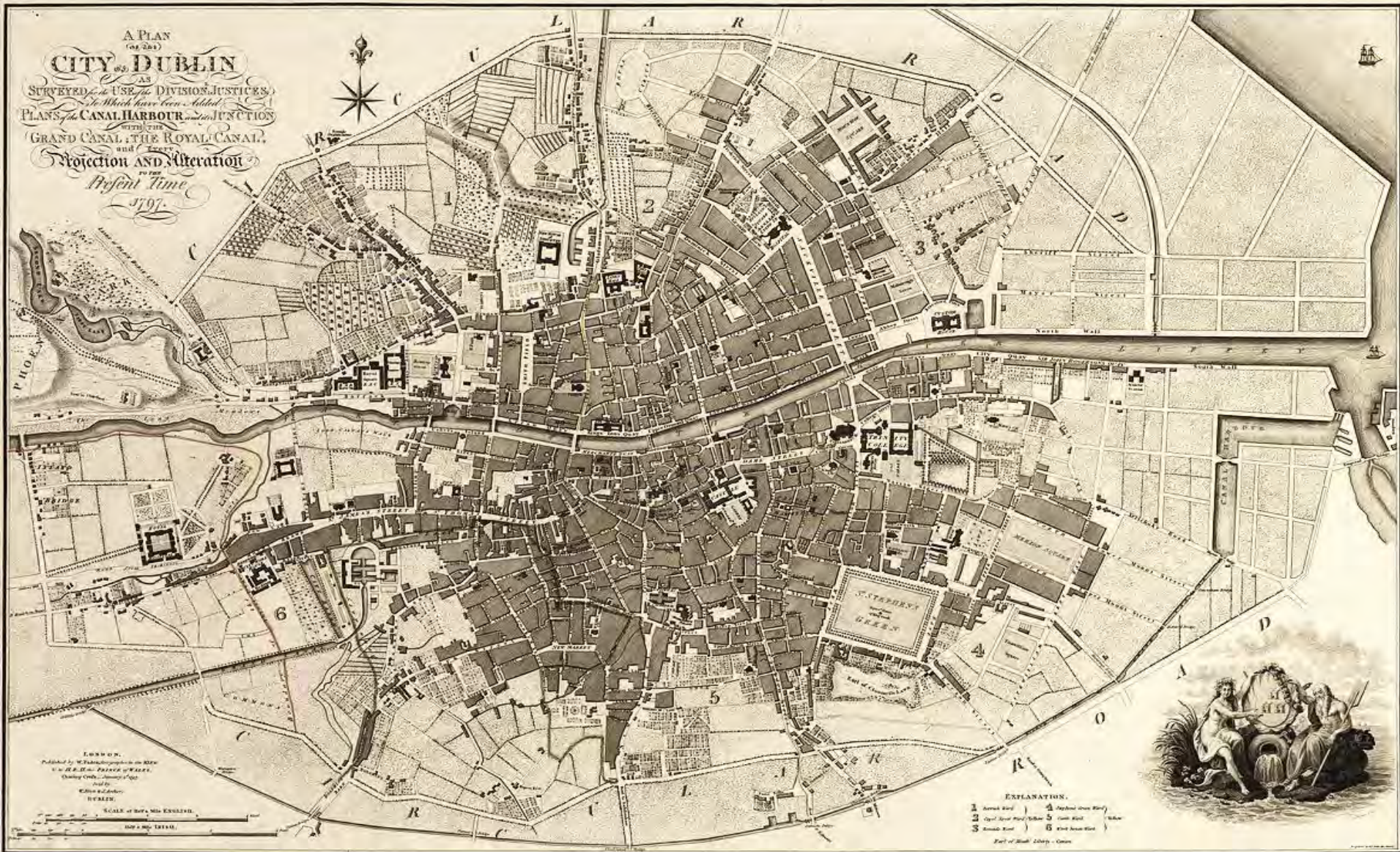

A Plan of the City of Dublin 1797

The Historic City
 Founded 988 AD



Dublin 2014

The City Context

City and County Population: 1 273 069 (2011)



'Dutch Billies' Longford Street 18C 9/9a Aungier Street 1664

Mansion House 1710

Earliest Surviving Houses Pre-Georgian Townhouse



View of Rutland Square James Malton 1793

The Georgian Context The 18th Century Townhouse



Sean Treacy House Paul Keogh Architects 2012



Timberyard O'Donnell + Tuomey 2009

City Centre Apartments

Creating contemporary streetscapes in historic contexts



Cigar Box Apartments Dennis Byrne Architects 2004

City Centre Apartments Re-imagining the Georgian 'Town House'



Church Street photographed in 1932

Artisan Houses Housing the 19th Century Workforce



Artisan housing Dublin Artisan Dwelling Corporation photographed in 2014

Artisan Houses

High density terraces - brick construction



Plastic House Architecture Republic 2009

Artisan Houses Extended

Extension as object contained within existing house



Terrace Modification Donaghy and Dimond 2009

Artisan Houses Extended

Extension cantilevered from existing house



Chancery Lane photographed in 1913

19th Century Tenements
Overcrowded conditions in former mansions



Henrietta House HG Simms, Dublin Corporation Housing Architect 1937

Dublin Corporation Flat Complexes
Galleries overlooking courtyards - Expressionist brick detailing



Memorial Court City Architects 2007



Thornton Heights City Architects 2014

Contemporary Flat Complexes
Balance between public and private spaces



Ballyfermot Crescent HG Simms, Dublin Corporation Housing Architect 1947



Beyond Pebbledash Kearns and Ruimy 2014

Expansion of the City

New suburbs constructed on outskirts of city - Garden City influence



House 4 Taka 2011

Expansion of the City Re-imagined



Brick Thickness A2 Architects 2006



Out The Front Cast Architecture 2011

Expansion of the City
Presenting a new face



House 1 + House 2 Taka 2009



Long House Grafton Architects 2001

Small Domestic
Interpretation of traditional 'mews' typology



Alma Lane Boyd Cody 2004



Brick House FKL 2001

Small Domestic

Interpretation of traditional 'mews' typology - house treated as distinct object



Seven Square Meters GKMP 2014

Eaton Square Lucy Jones 2013

Small Domestic
Subtle interventions to bring outside in



Mimetic House **Dominic Stevens** 2007

Small Domestic Responding to the landscape



Farmhouse Extension Studio Red 2012

Small Domestic
Responding to the landscape



Boat House BCDH 2012



Slievebawnogue House Clancy Moore 2014

Small Domestic
Responding to the landscape



Carvel Chair **Déanta** from Makers and Brothers

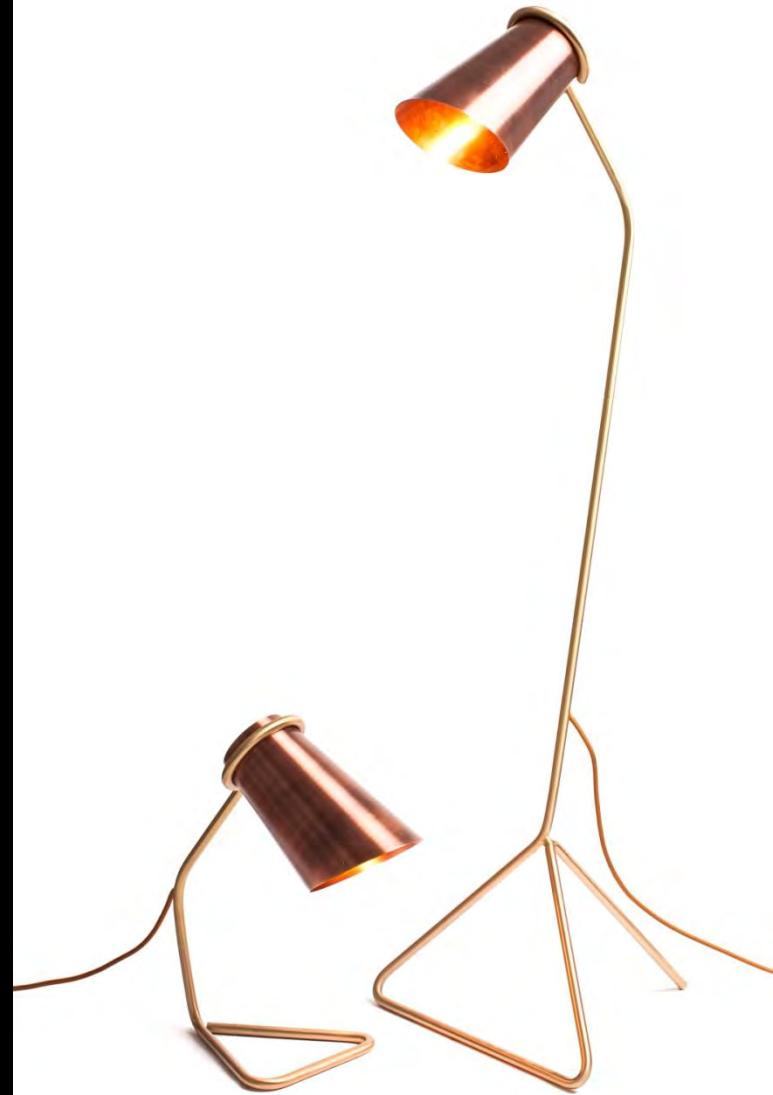

Strand Lamp **Déanta** from Makers and Brothers

Product Design



Klickity Kate Cronin & Liz Fingleton

Obeo Kate Cronin & Liz Fingleton

Product Design



As if from Nowhere Orla Reynolds

Product Design



Dublin House 1.0 Dublin City Architects. images by GKMP and Moniker 2009

The DUBLIN HOUSE project
An economic, social and architectural opportunity



Dublin House 2.0 Dublin City Architects. images by GKMP and Moniker 2009

The DUBLIN HOUSE project

An economic, social and architectural opportunity

A large crowd of people is gathered in a paved courtyard in front of a modern, multi-story brick and grey metal building. The building features balconies with glass railings and large windows. The sky is blue with scattered white clouds. The scene is an outdoor event, likely an opening ceremony, with people of various ages and backgrounds. Some are standing in groups, while others are walking. A white tent is visible on the right side of the image. The overall atmosphere is bright and social.

Thank You

pivotdublin.com dublincityarchitects.ie
design@dublincity.ie

Thornton Heights, Opening Ceremony, 2014